



**XT Series**

**Install Instructions For:**

XT550, XT550-UL, XT850, and XT850-UL

1.435.647.9555 | 800.647.TUBE | www.soundtube.com

**Box contents**

- 1 In-ground speaker
- 1 Anti-theft device (2 pieces)
- 1 Liquid-tight compression fitting
- 1 Square drive bit
- 2 Wire nuts
- 6 #8 stainless-steel square-drive screws
- 2 .75" 1/4-20 Stainless-steel bolts

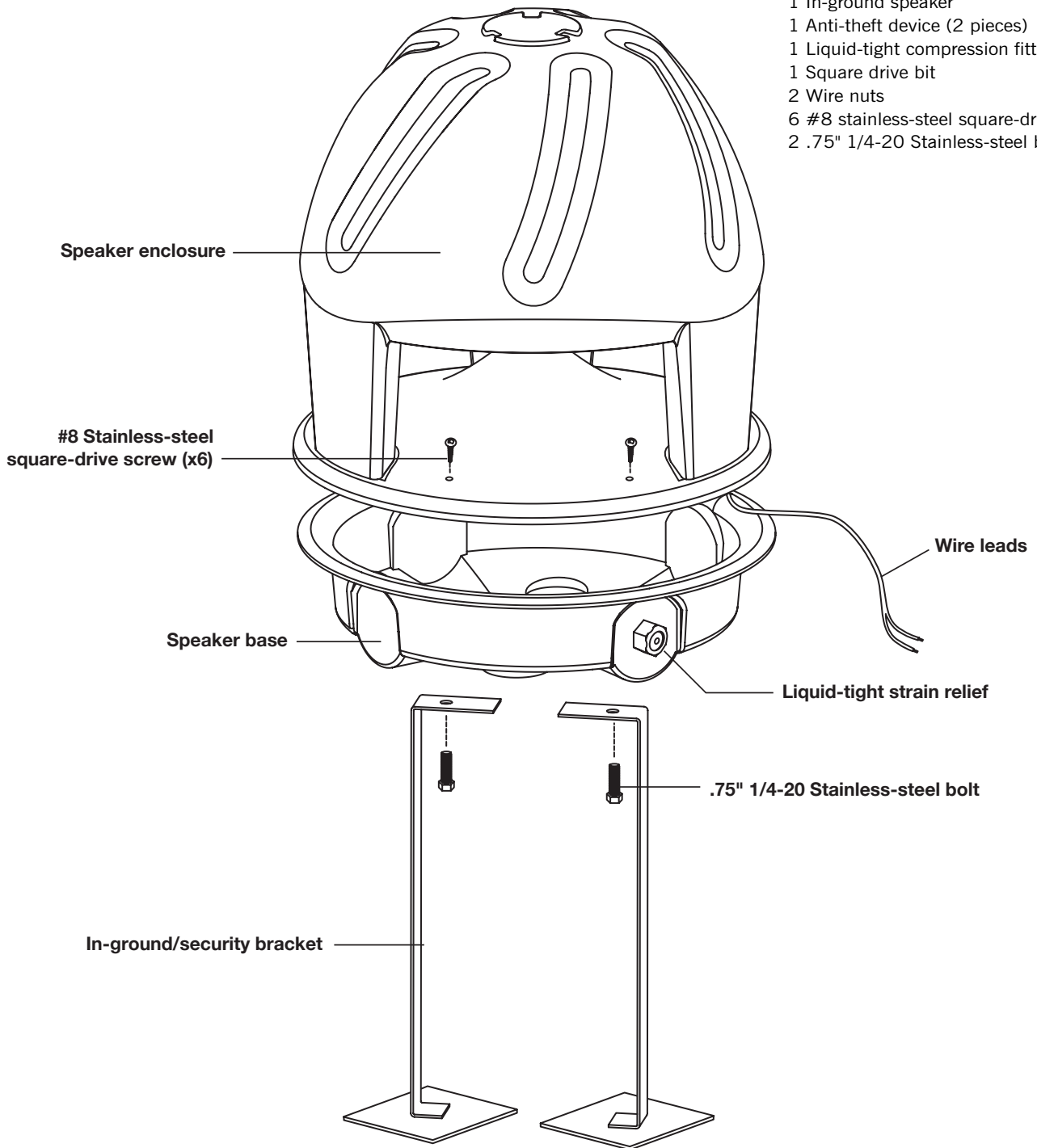

**Transformer Taps Settings**

© 2005 SoundTube Entertainment, Inc. All rights reserved. PN INS-XT Rev05.26.05

|              | Voice Coil   | 70.7 Volt Transformer Taps (dB)  | 100 Volt Transformer Taps (dB) | 25 Volt Transformer Taps (dB) |
|--------------|--------------|----------------------------------|--------------------------------|-------------------------------|
| <b>XT550</b> | 4 Ohm=107 dB | 32W=103, 16W=100, 8W=97, 4W=94   | 32W=103, 16W=100, 8W=97        | 4W=94, 2W=91, 1W=88, .5W=85   |
| <b>XT850</b> | 4 Ohm=110 dB | 64W=108, 32W=105, 16W=102, 8W=99 | 64W=108, 32W=105, 16W=102      | 8W=99, 4W=96, 2W=93, 1W=90    |

XT550-UL and XT850-UL UL listed 1480

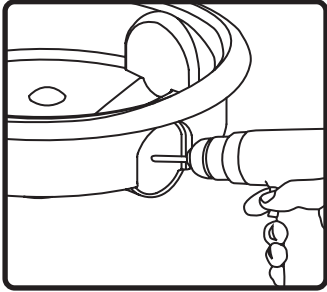

1. If needed for daisy chaining drill speaker base and install second liquid-tight strain relief (not included).

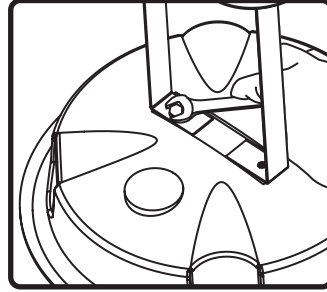

2. Attach inground/security brackets to speaker base using stainless-steel bolts.

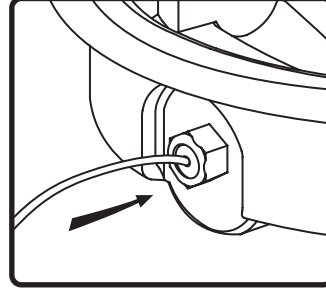

3. Thread signal wire thru liquid-tight strain relief and tighten seal.

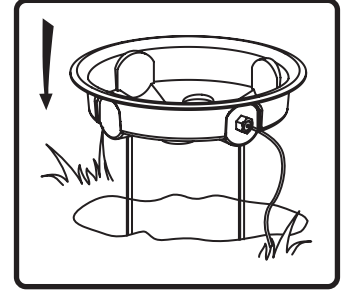

4. Place speaker base into hole in ground with the top rim of the base at ground level. Back-fill dirt in to hole, packing the dirt firmly. For added security, cement security brackets into ground.

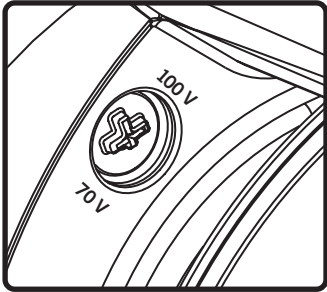

5. Select the tap position by removing the rubber plug to access rotary switch. Switch is preset to maximum tap setting in 70.7 V mode (64W XT850, 32W XT550). Select desired setting and reinsert rubber plug.

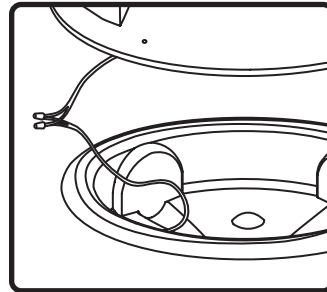

6. Attach signal wire to wire leads. Use wire nuts provided. For added water proofing, grease caps are recommended.

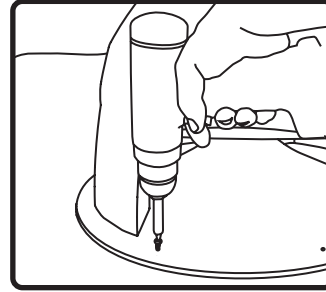

7. Set speaker enclosure on speaker base. Use tamper-resistant stainless-steel screws to attach speaker to base (driver tip and screws provided).

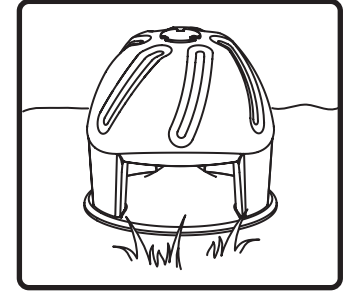

8. Done!

## Port option for XT550

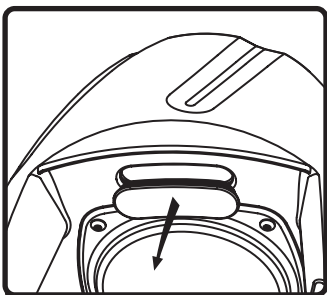

To enhance bass performance, remove port cover on the underside of speaker enclosure.

**Warning: Removing the cover will expose internal components to humidity and other potentially corrosive elements.**

## Warning

SoundTube speakers must be installed by a professional audio installer/contractor. For safety and for optimum audio performance, installer must follow all directions issued by SoundTube Entertainment.