

Outstanding Visibility with Quiet Operation

XS series

Easily installed in store windows, LG's XS series of window facing digital signage captivates customers with its vivid image quality and quiet operation. The XS series helps businesses enhance their store's brand image while enriching the customers' shopping experience.



Outstanding Visibility with Quiet Operation

XS series

Outstanding Visibility

High Brightness

With a great brightness of 2,500 cd/m², XS series clearly delivers contents and attracts public attention, which is the ultimate display for outdoor visibility.



Visible with Polarized Sunglasses

QWP^(Quarter Wave Plate) enables clear visibility even when the viewer is wearing polarized sunglasses.



Outstanding Visibility with Quiet Operation

XS series

Quiet Operation

Fan-less Design

By eliminating the need for a cooling fan, we have made the XS series an ideal choice for the in-window environment. Its operating noise level is under 25dB, which is quieter than that of daily conversation.

XS Series
(Under 25dB)



Conversation
(50dB)



Typing
(78dB)



Space Efficiency

Slim Design

Thanks to its thin depth, the XS series takes up less space, which leads to space efficiency in an in-window environment.



Outstanding Visibility with Quiet Operation

XS series

User Convenience

webOS Smart Platform

Quad Core SoC (System-on-Chip) can execute several tasks at the same time without a separate media player. In addition, webOS 3.0 platform enhances user convenience with intuitive UI and simple app development tools.

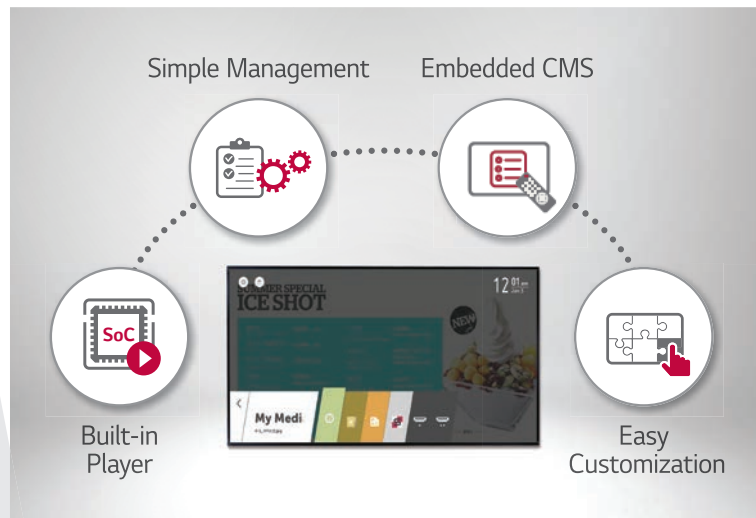

Smart Brightness Control

The screen brightness is automatically adjusted depending on the ambient light. The brightness is increased in light for better visibility, while it is decreased in darkness for efficient power management.



Dimension (unit: mm)

75"

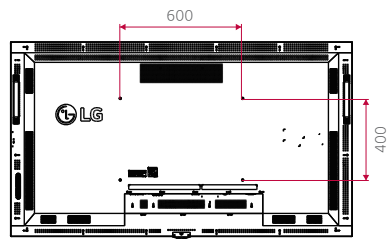
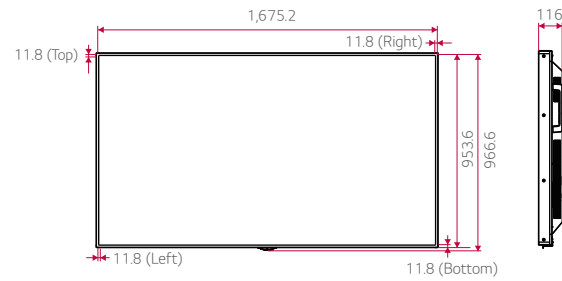

55"

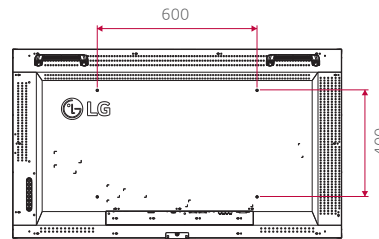
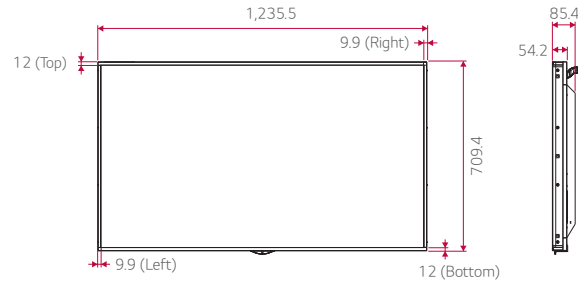

49"

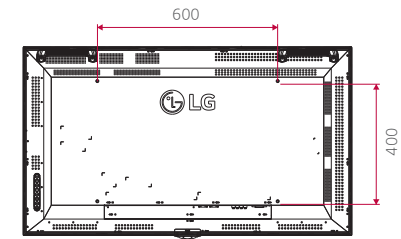
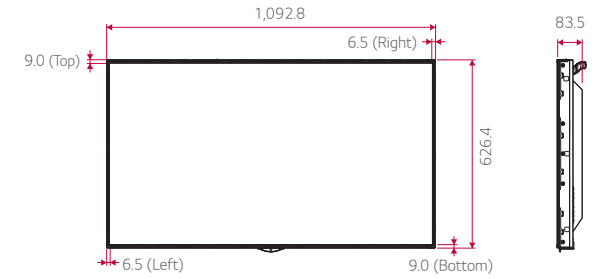

Connectivity

75"

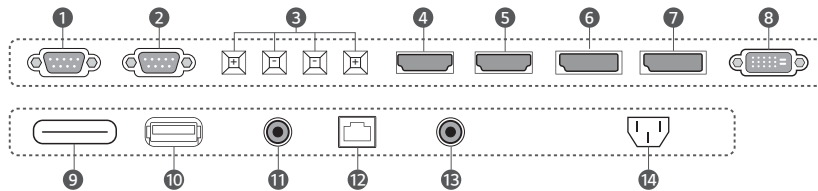

- 1 RS 232C IN
- 2 RS 232C OUT
- 3 SPEAKER OUT (8 Ω)
- 4 HDMI IN 1
- 5 HDMI IN 2
- 6 DP IN
- 7 DP OUT
- 8 DVI-D IN
- 9 SD CARD
- 10 USB IN
- 11 AUDIO IN (PC)
- 12 LAN
- 13 IR & LIGHT SENSOR
- 14 AC IN

55"/49"

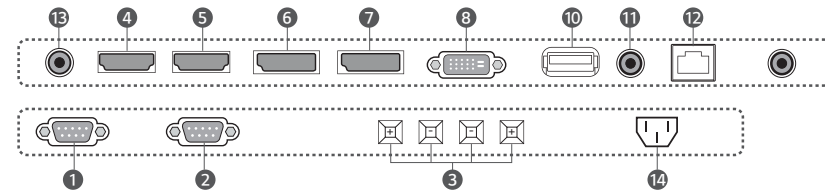

Specifications

| | 75XS2E | 55XS2E | 49XS2E | |
|--|---|--|--|--|
| PANEL | Screen Size | 75" (74.52" Measured Diagonal) | 55" (54.64" Measured Diagonal) | 49" (48.50" Measured Diagonal) |
| | Panel Technology | IPS, M+ (WRGB) | IPS, M+ (WRGB) | IPS, M+ (WRGB) |
| | Aspect Ratio | 16 : 9 | 16 : 9 | 16 : 9 |
| | Native Resolution | 3,840 x 2,160 (UHD) | 1,920 x 1,080 (FHD) | 1,920 x 1,080 (FHD) |
| | Brightness | 2,500 cd/m ² (Typ.), 2,250 cd/m ² (Min.) | 2,500 cd/m ² (Typ.), 2,250 cd/m ² (Min.) | 2,500 cd/m ² (Typ.), 2,250 cd/m ² (Min.) |
| | Contrast Ratio (Typ.) | 1,200:1 | 1,000:1 | 1,000:1 |
| | Viewing Angle (H x V) | 178 x 178 | 178 x 178 | 178 x 178 |
| | Surface Treatment | Haze 3%, QWP | Haze 3%, QWP | Haze 3%, QWP |
| | Lifetime | 50,000 Hrs | 50,000 Hrs | 50,000 Hrs |
| | Operation Hours | 24 Hrs | 24 Hrs | 24 Hrs |
| Orientation | Landscape & Portrait | Landscape & Portrait | Landscape & Portrait | |
| CONNECTIVITY | Input | HDMI(2), DP, DVI-D, Audio, USB, SD Card | HDMI(2), DP, DVI-D, Audio, USB | HDMI(2), DP, DVI-D, Audio, USB |
| | Output | DP, External Speaker (L/R) | DP, External Speaker (L/R) | DP, External Speaker (L/R) |
| | External Control | RS232C In/out, RJ45 In, IR Receiver In | RS232C In/out, RJ45 In, IR Receiver In | RS232C In/out, RJ45 In, IR Receiver In |
| PHYSICAL SPECIFICATION | Bezel Color | Black | Black | Black |
| | Bezel Width | 11.8 mm (Even) | 12.0 mm (T/B), 9.9 mm (L/R) | 9 mm (T/B), 6.5 mm (L/R) |
| | Monitor Dimension (W x H x D) | 1,675.2 x 953.6 x 116 mm | 1,235.5 x 709.4 x 85.4 mm | 1,092.8 x 626.4 x 83.5 mm |
| | Weight (Head) | 43 kg | 24.7 kg | 20.2 kg |
| | Carton Dimensions (W x H x D) | 1,816 x 1,106 x 285 mm | 1,344 x 215 x 820 mm | 1,194 x 175 x 760 mm |
| | Packed Weight | 52.2 kg | 29.9 kg | 24.7 kg |
| | Handle | Yes (2ea) | Yes (2ea) | Yes (2ea) |
| | VESA™ Standard Mount Interface | 600 x 400 mm | 600 x 400 mm | 600 x 400 mm |
| SPECIAL FEATURES | Internal Memory (8GB, System 4GB + Available 4GB), Wi-Fi Dongle Ready, Temperature Sensor, Auto Brightness Sensor, Smart Energy Saving, USB Auto Playback, Local Contents Scheduling, Content Sync (RS232C, Local Network), OSD Rotation, Content Rotation, Tile Mode (Up to 15x15), Firmware Update by Network, SNMP, ISM Mode, Control Manager, DPM, PM Mode, Wake on LAN, HDMI-CEC ¹⁾ | | | |
| ENVIRONMENTAL CONDITIONS | Operation Temperature ²⁾ | 0°C to 40°C | 0°C to 45°C | 0°C to 45°C |
| | Operation Humidity | 10% to 85% | 10% to 80% | 10% to 80% |
| POWER | Power Type | Built-In Power | Built-In Power | Built-In Power |
| | Power Supply | 100-240V~, 50/60Hz | 100-240 V~, 50/60 Hz | 100-240V~, 50/60Hz |
| | Power Typ. / Max. | 585 W / 600 W | 240 W / 270 W | 200 W / 240 W |
| | Consumption Smart Energy Saving | 280 W | 120 W | 100 W |
| STANDARD (CERTIFICATION) | Safety | IEC 60950-1 / EN 60950-1 / UL 60950-1 | IEC 60950-1 / EN 60950-1 / UL 60950-1 | IEC 60950-1 / EN 60950-1 / UL 60950-1 |
| | EMC | FCC Class "A" / CE / KC / VCCI | FCC Class "A" / CE / KC / VCCI | FCC Class "A" / CE / KC / VCCI |
| | ErP / Energy Star | No / No | No / No | No / No |
| SOFTWARE COMPATIBILITY³⁾ | Content Management Software | SuperSign CMS | SuperSign CMS | SuperSign CMS |
| | Control and Monitoring Software | SuperSign Control / Control+ | SuperSign Control+ | SuperSign Control+ |
| ACCESSORIES | Basic | Remote Controller, Power Cord, HDMI Cable, Manual (ESG/EIG), IR Receiver (w/ Ambient Light Sensor) | Remote Controller, Power Cord, HDMI Cable, Manual (ESG/EIG), IR Receiver (w/ Ambient Light Sensor) | Remote Controller, Power Cord, HDMI Cable, Manual (ESG/EIG), IR Receiver (w/ Ambient Light Sensor) |
| | Optional | Wall Mount (LSW630), Wi-Fi Dongle (AN-WF500) | Landscape Wall Mount (WM-L640V), Portrait Wall Mount (WM-P640V), Wi-Fi Dongle (AN-WF500) | Landscape Wall Mount (WM-L640V), Portrait Wall Mount (WM-P640V), Wi-Fi Dongle (AN-WF500) |

1) Compatibility may differ by equipment. 2) Without direct sunlight or with cooling systems in direct sunlight. 3) Software compatibility may change over time. Please contact your regional LG sales representative for details.



Download
LG C-Display+
Mobile App

Google Play Store

- www.lg.com/b2b
- www.youtube.com/c/LGCommercialDisplay
- www.facebook.com/LGInformationDisplay
- www.linkedin.com/company/LGInformationDisplay

LG may make changes to specifications and product descriptions without notice.
Copyright © 2018 LG Electronics Inc. All rights reserved. "LG Life's Good" is a registered trademark of LG Corp.
The names of products and brands mentioned here may be the trademarks of their respective owners.

