



RF31-EZ

Install Instructions For:
RF31-EZ speaker

Box contents

- 1 Speaker
- 1 Grille
- 2 Wire nuts
- 4 Mounting screws

Optional Accessories

- Theft-resistant, stainless steel grille (AC-RF31-TRG)

NOTE: the RF31-EZ is designed to install into a standard 2-gang junction box. SoundTube recommends you test the fit before installing the junction box.

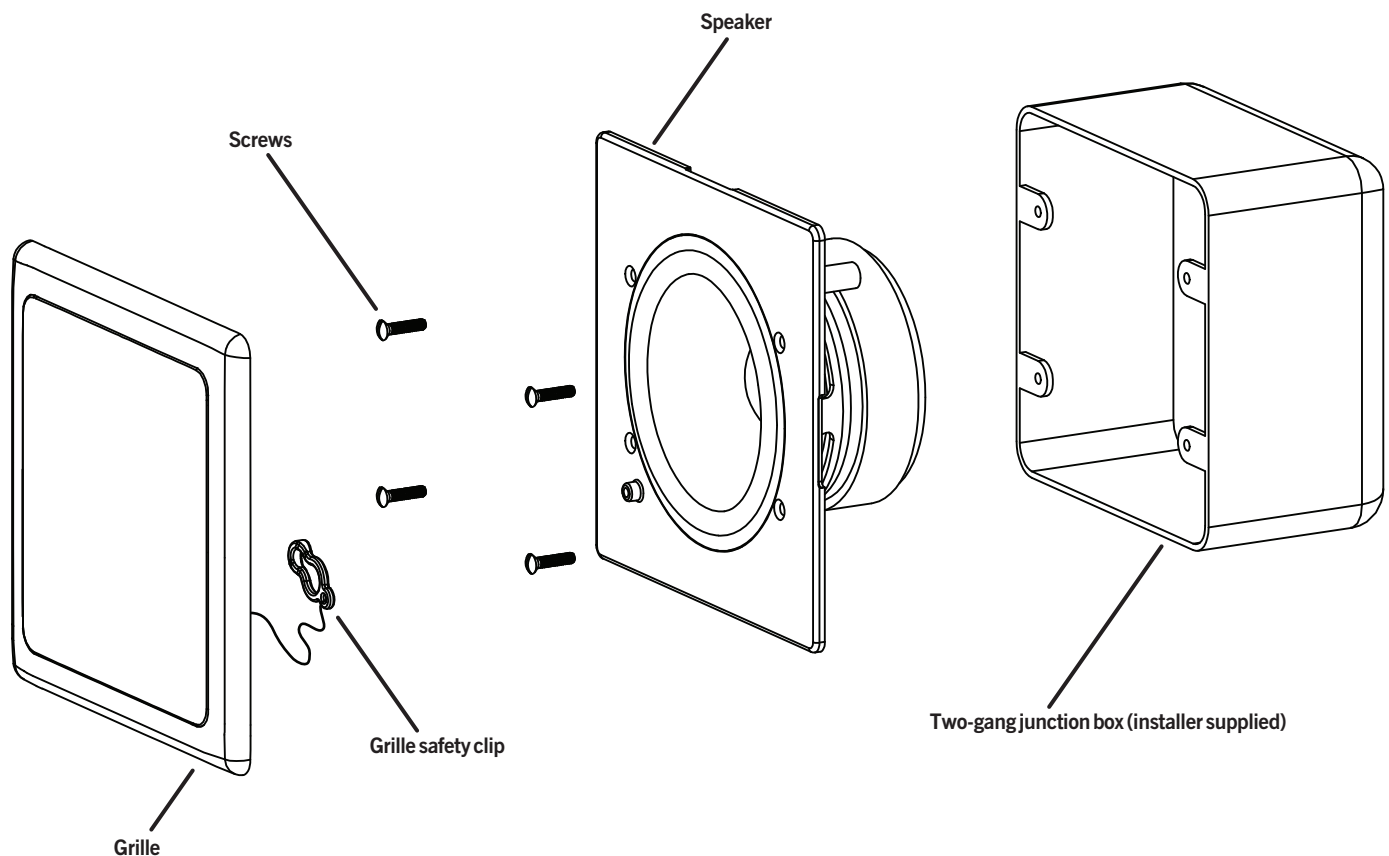

© 2010 SoundTube Entertainment, Inc. All rights reserved. PN INS-RF-31 Rev 05.20.10

Warning

SoundTube speakers must be installed by a professional audio installer/contractor. For safety and for optimum audio performance, installer must follow all directions issued by SoundTube Entertainment.

Warning

Do not spec or install speaker near support beam, ventilation duct or other structure that may interfere with speaker function or dispersion.

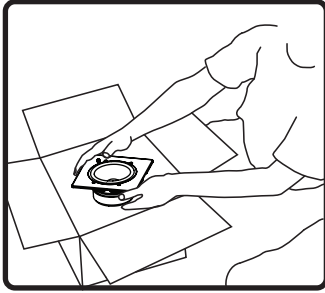

1. Unpack speaker.

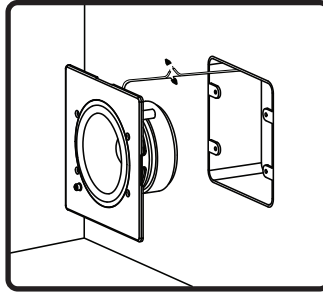

2. Connect speaker wires to signal wires using included wire nuts.

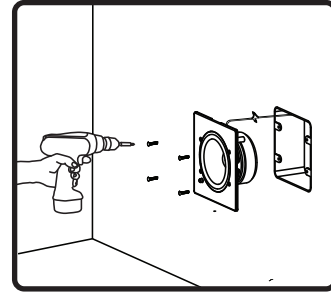

3. Install the RF31-EZ into the installer supplied junction box using included fasteners.

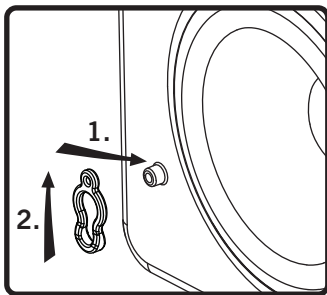

4. Attach grille safety clip by placing the large end of the clip over snap-fit post (1), then sliding clip until small end snaps into place around post (2).

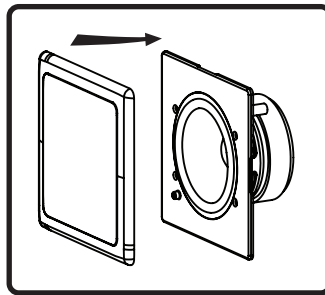

5. Align tabs on snap-fit grille with slots in baffle, gently press grille into place.

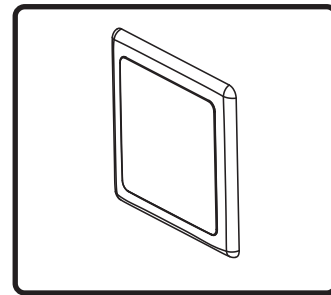

6. Done!