



4x2 Switcher for HDMI 1.3

EXT-HDMI1.3-442
User Manual



www.gefen.com

ASKING FOR ASSISTANCE

Technical Support:

Telephone (818) 772-9100
(800) 545-6900

Fax (818) 772-9120

Technical Support Hours:

8:00 AM to 5:00 PM Monday thru Friday PST

Write To:

Gefen, LLC.
c/o Customer Service
20600 Nordhoff St
Chatsworth, CA 91311

www.gefen.com
support@gefen.com

Notice

Gefen, LLC reserves the right to make changes in the hardware, packaging and any accompanying documentation without prior written notice.

4x2 Switcher for HDMI 1.3 is a trademark of Gefen, LLC

HDMI, the **HDMI** logo, and **High-Definition Multimedia Interface** are trademarks or registered trademarks of HDMI Licensing in the United States and other countries.

© 2011 Gefen, LLC. All rights reserved.
All trademarks are the property of their respective owners.

CONTENTS

- 1 Introduction
- 2 Operation Notes
- 3 Features
- 4 Panel Layout
- 5 Panel Descriptions
- 6 Connecting And Operating The 4x2 Switcher For HDMI 1.3
- 7 IR Remote Control
 - 7 Layout and Description
 - 8 Installing the Battery
 - 8 Setting the IR Channel
- 10 EDID Management
 - 10 EDID Mode Selection
 - 11 External EDID Management
- 12 Specifications
- 13 Warranty

INTRODUCTION

Congratulations on your purchase of the 4x2 Switcher for HDMI 1.3. Your complete satisfaction is very important to us.

Gefen

Gefen delivers innovative, progressive computer and electronics add-on solutions that harness integration, extension, distribution and conversion technologies. Gefen's reliable, plug-and-play products supplement cross-platform computer systems, professional audio/video environments and HDTV systems of all sizes with hard-working solutions that are easy to implement and simple to operate.

The Gefen 4x2 Switcher for HDMI 1.3

Gefen's 4x2 Switcher for HDMI 1.3 is equipped with four (4) HDMI inputs and two (2) HDMI outputs. Two inputs accommodate the simultaneous connection of up to two high definition video sources, such as satellite systems and Blu-Ray players. 3D content can be displayed when connecting a 3DTV and 3D source. Two outputs send the high definition audio/video signals to up to two HDTV displays. Switching is done via the included IR remote.

How It Works

Connect all your sources to the 4x2 Switcher for HDMI 1.3 inputs. Then connect up to two displays on the output ports. Once the sources, the switcher and the displays are powered and connected, you then select which source you want to view using the IR remote.

OPERATION NOTES

READ THESE NOTES BEFORE INSTALLING OR OPERATING THE 4X2 SWITCHER FOR HDMI 1.3

- By default, display information from the display connected to HDMI output port 1 is sent back to the source. Therefore, the other display connected to the 4x2 Switcher for HDMI 1.3 must be capable of accepting the timings, resolutions and audio formats of the display that is connected to HDMI output port 1. It is recommended that the display with the lowest native resolution be connected to HDMI output port 1. This is to ensure that a compatible video signal will be able to be displayed on all connected monitors. There is a generic EDID programmed into the 4x2 Switcher for HDMI 1.3 that can be used instead. See page 10 for more details on using EDID.

FEATURES

HDMI 1.3 Features

- 225 MHz (up to 12 bit YUV 444 supported @ 1080p)
- Deep Color
- Dolby TrueHD and DTS-HD Master Audio
- Lip Sync
- CEC Pass-Through

Features

- Easily switch between any four (4) Hi-Def sources on up to two (2) HDTV displays without signal loss
- Maintains sharp HDTV resolutions up to 1080p Full HD and 2K
- 3DTV Pass-Through
- Color Space Conversion
- EDID Management for rapid integration of sources and display devices.
- Mono-LOK™ Locking HDMI Connectors
- Supports the use of DVI sources and DVI displays with an HDMI-to-DVI converter cable or adapter
- HDMI and HDCP compliant

Package Includes

- (1) Gefen 4x2 Switcher for HDMI 1.3
- (2) 6 ft. HDMI cables (M-M)
- (1) IR Remote Control Unit
- (1) 5V DC Power Supply
- (1) User Manual

PANEL LAYOUT

Front Panel

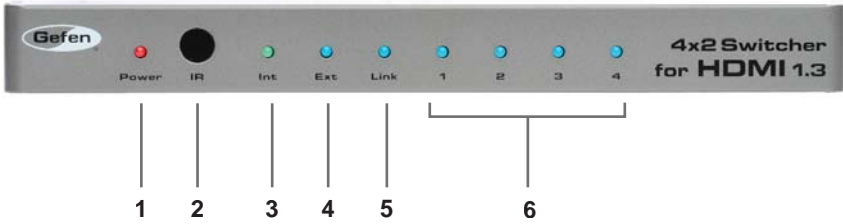

Back Panel

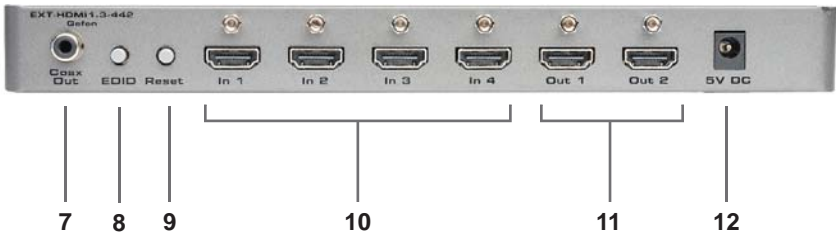

PANEL DESCRIPTIONS

1 Power Indicator

This LED will become active once the included 5V DC power supply is properly connected between the unit and a open wall power receptacle.

2 IR (Infrared) Receiver

This receiver will accept command for switching between input HDMI devices using the included RMT-4IR remote control.

3 Internal EDID Mode Indicator

This LED will become active when the unit is using the pre-loaded EDID. See page 10 for more details.

4 External EDID Mode Indicator

This LED will become active when the unit is using the EDID from the HDMI deice connected to HDMI output port 1. See page 6 for more details.

5 Link Indicator

This LED will become active when the unit is properly connected to an HDMI capable device on either of the HDMI output ports.

6 Input Indicators

There is one LED for each of the four input ports. The LED for the currently selected HDMI input will be active.

7 S/PDIF Digital Audio Output Connector

This S/PDIF output will supply supported audio formats for output to an external audio decoder or device such as an amplifier or receiver.

8 EDID Button

This button will toggle between the internal external EDID modes. To determine which mode is currently being used, please note which EDID mode LED is active on the front panel of the unit.

9 Reset Button

This button will reset the unit and force all devices in the chain to re-transmit/ re-read EDID. It is essential that the unit be reset after the EDID mode has been changed.

10 HDMI Input Ports 1-4

Connect up to four (4) Hi-Def sources these HDMI input ports.

11 HDMI Output Ports 1-2

Connect up to two (2) HDTV displays to these HDMI output ports.

12 5V DC Power Receptacle

Connect the included 5V DC power supply between this port and an open wall power receptacle.

CONNECTING AND OPERATING THE 4X2 SWITCHER FOR HDMI 1.3

How to Connect the 4x2 Switcher for HDMI 1.3

1. Connect up to two HDMI source devices to the 4x2 Switcher for HDMI 1.3 using the supplied HDMI cables.
2. Connect up to four HDMI capable devices to the 4x2 Switcher for HDMI 1.3 using the supplied HDMI cables.
3. Connect the included 5V DC power adapter to the 4x2 Switcher for HDMI 1.3 power input port.
4. Power on the displays first and then the source.

Wiring Diagram for the Gefen 4x2 Switcher for HDMI 1.3

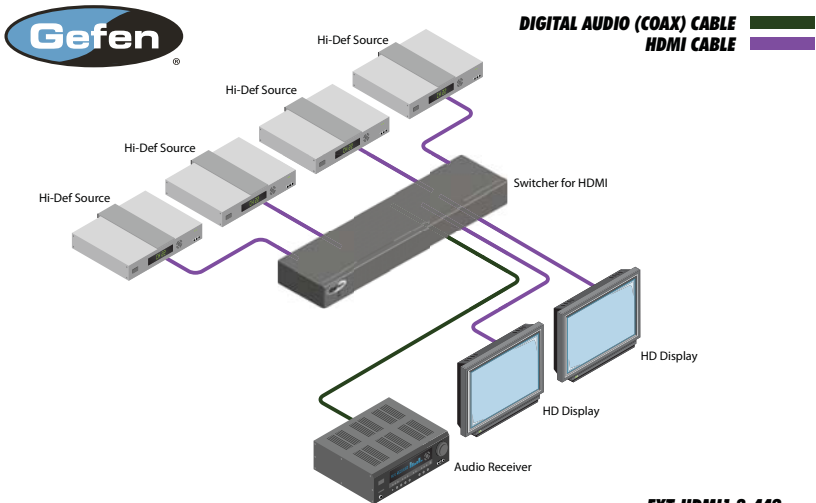

IR REMOTE CONTROL

Layout and Description (RMT-4IR)



- 1** **LED Button Press Indicator**
This LED will be activated momentarily each time a button is pressed.
- 2** **Display and Source Selection Buttons**
These buttons are used to select which source is routed to a display. The Source and Display buttons are mapped as follows:



NOTE: An Activity Indicator that flashes quickly while holding down any one of the four buttons indicates a low battery. Replace the IR Remote Control battery as soon as possible.

IR REMOTE CONTROL

Installing the Battery

The Remote Control unit ships with two batteries (CR-2032 lithium battery). One battery is required for operation and the other battery is a spare.

1. Remove the battery cover on the back of the IR Remote Control unit.
2. Insert the included battery into the open battery slot. The positive (+) side of the battery should be facing up.
3. Replace the battery cover.

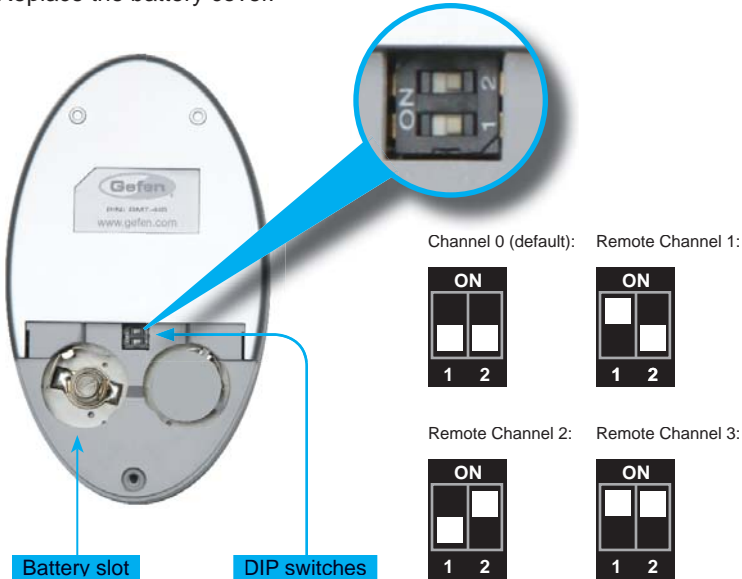

Setting the IR Channel

The IR channel on the IR Remote Control must match the IR channel used by the *4x2 Switcher for HDMI 1.3*. For example, if both DIP switches on the IR Remote Control unit are set to IR channel 0 (both DIP switches down), then the *4x2 Switcher for HDMI 1.3* must also be set to IR channel 0. See the next page for information on how to change the IR channel on the *4x2 Switcher for HDMI 1.3*.



WARNING: Risk of explosion if battery is replaced by an incorrect type. Use only CR-2032 3V lithium batteries.

IR CHANNEL CONTROL

Use the following procedure to set the proper IR channel on the 4x2 Switcher for HDMI 1.3.

- 1 Press and hold the **EDID** button.
- 2 While holding the **EDID** button, press and release the **Reset** button. The input LED indicators, on the front panel, will represent the current IR channel for the Switcher: A blinking LED corresponds to DIP switch set to the ON position. An inactive LED corresponds to a DIP switch set to the OFF position.



In the illustration above, the LED for Input 1 is blinking and the LED for Input 2 is inactive. This indicates that the Switcher is set to IR channel 1.

IMPORTANT: The selected IR channel must be the same as the IR channel set on the IR Remote Control Unit (see previous page). Refer to the table below for setting the IR channel on the 4x2 Switcher for HDMI 1.3.

IR Channel Table

Input LED 1	Input LED 2	IR Channel
OFF	OFF	0
OFF	ON	1
ON	OFF	2
ON	ON	3

- 3 Continue holding the **EDID** button while pressing and releasing the **Reset** button to cycle to the next IR channel.
- 4 Once the proper IR channel has been selected, release the **EDID** button.

EDID MANAGEMENT

EDID Mode Selection

1. EXTERNAL MODE:

See the next page for details on using the External EDID.

2. INTERNAL MODE:

To use this mode, press the EDID button on the rear panel until the front-panel LED marked "Int" turns bright green. This mode will use a preset EDID, from the factory, that is stored in the Gefen 4x2 Switcher for HDMI 1.3. This pre-programmed standard EDID data structure is compatible with most A/V display devices. All resolutions and audio formats specified in this EDID will be passed to the source device. See the tables below for a complete listing of the resolutions and audio formats listed in this EDID.

NOTE: All other HDMI devices/displays connected to the output ports **MUST** be compatible with at least one resolution/audio format specified in this EDID. It is recommended to set, on the source device, a common resolution and audio format shared by all attached devices/displays. This is to ensure a compatible signal is output to all connected devices/displays.

Internal EDID Video Timings

Timing	Refresh Rate	Timing	Refresh Rate
1280 x 720p	50 Hz	720 x 576p	50 Hz
1280 x 720p	59.94 / 60 Hz	1920 x 1080p	50 Hz
1920 x 1080i	50 Hz	1920 x 1080p	59.94 / 60 Hz
1920 x 1080i*	59.94 / 60 Hz	1440 x 480p	59.94 / 60 Hz
720 x 480p	59.94 / 60 Hz	1440 x 576p	50 Hz

* Native Resolution

Internal EDID Audio Formats

Audio Format	Supported Channels
LPCM	2CH
AC-3	2CH / 5.1CH
DTS	2CH / 5.1CH

External EDID Management

The 4x2 Switcher for HDMI 1.3 features EDID Management. Before the source can send video or audio signals, the source device reads the EDID (Extended Display Identification Data) from the output devices connected to the Splitter. The EDID contains information about what type of A/V data that the source can send to each output device.

The 4x2 Switcher for HDMI 1.3 distributes a single source to multiple output devices. This involves reading EDID data from more than one device. Management of the EDID data is important to maintain compatibility between all devices.

The following EDID features are copied from Output 1:

- Supported Resolutions
- 3D Support
- Audio Features

EDID color features are built based on all attached displays, using the following rules:

- Deep Color will be *enabled* if one or more displays are connected to the Splitter supporting Deep Color.
- xvYCC (x.v.Color) is supported if all connected displays support it.

Display Connections:

- If a display is not connected to Output 1, then no EDID changes are made, meaning that the previous EDID information will be used. This state will be in effect until a display is connected to Output 1 and the Splitter is power-cycled.
- EDID is built from Output 1 to the Input. The audio block will be copied from Output 1. EDID-copying is performed only when the Splitter is reset or power-cycled.

SPECIFICATIONS

Video Amplifier Bandwidth	225 MHz
Input Video Signal	1.2 Volts p-p
Input DDC Signal	5 Volts p-p (TTL)
HDMI Input Connectors	(4) Type A, 19 Pin, Female
HDMI Output Connectors	(2) Type A, 19 Pin, Female
Power Supply	5V DC
Power Consumption	10 Watts (max)
Operating Temperature	0 - 40 °C
Dimensions	12" W x 1.2" H x 4.2" D
Shipping Weight	6 lbs.

WARRANTY

Gefen warrants the equipment it manufactures to be free from defects in material and workmanship.

If equipment fails because of such defects and Gefen is notified within two (2) years from the date of shipment, Gefen will, at its option, repair or replace the equipment, provided that the equipment has not been subjected to mechanical, electrical, or other abuse or modifications. Equipment that fails under conditions other than those covered will be repaired at the current price of parts and labor in effect at the time of repair. Such repairs are warranted for ninety (90) days from the day of reshipment to the Buyer.

This warranty is in lieu of all other warranties expressed or implied, including without limitation, any implied warranty or merchantability or fitness for any particular purpose, all of which are expressly disclaimed.

1. Proof of sale may be required in order to claim warranty.
2. Customers outside the US are responsible for shipping charges to and from Gefen.
3. Copper cables are limited to a 30 day warranty and cables must be in their original condition.

The information in this manual has been carefully checked and is believed to be accurate. However, Gefen assumes no responsibility for any inaccuracies that may be contained in this manual. In no event will Gefen be liable for direct, indirect, special, incidental, or consequential damages resulting from any defect or omission in this manual, even if advised of the possibility of such damages. The technical information contained herein regarding the features and specifications is subject to change without notice.

For the latest warranty coverage information, refer to the Warranty and Return Policy under the Support section of the Gefen Web site at www.gefen.com.

PRODUCT REGISTRATION

Please register your product online by visiting the Register Product page under the Support section of the Gefen Web site.



20600 Nordhoff St., Chatsworth CA 91311

1-800-545-6900 818-772-9100 fax: 818-772-9120

www.gefen.com support@gefen.com



This product uses UL listed power supplies.