

Gefen

HDMI Super Booster Plus

USER MANUAL



www.gefen.com

ASKING FOR ASSISTANCE

Technical Support:

Telephone (818) 772-9100
(800) 545-6900

Fax (818) 772-9120

Technical Support Hours:

8:00 AM to 5:00 PM Monday thru Friday.

Write To:

Gefen Inc.
C/O Customer Service
20600 Nordhoff St.
Chatsworth, CA 91311

support@gefen.com
www.gefen.com

Notice

Gefen Inc. reserves the right to make changes in the hardware, packaging and any accompanying documentation without prior written notice.

The HDMI Super Booster Plus is a trademark of Gefen Inc.

© 2008 Gefen Inc., All Rights Reserved

TABLE OF CONTENTS

- 1 Introduction
- 2 Features
- 3 Panel Descriptions
- 4 Connecting and Operating the HDMI Super Booster Plus
- 5 Auto Equalization
- 6 Specifications
- 7 Warranty

INTRODUCTION

The Gefen HDMI Super Booster Plus is an attractive alternative to the traditional sender/receiver solutions for HD extension. The HDMI Super Booster Plus enables your standard “off the shelf” HDMI cable to transmit HDTV video plus multichannel digital audio in a single cable way beyond the limited HDMI specification of 15-feet.

Up to 200 feet can be easily traversed using your HDMI cable plus a HDMI Super Booster Plus. The HDMI Super Booster Plus corrects any digital degradation that occurs when HDMI is used to send digital audio/video signals beyond the HDMI specification of 15 feet.

How It Works

This plug and play installation takes mere seconds. You simply connect the HDMI cable on one side of the HDMI Super Booster Plus and the display’s cable on the other side. The HDMI Super Booster Plus sits between the end of your HDMI cable and your display. You also have the option of connecting another HDMI cable to the Booster, daisy chaining Boosters and cables for greater distances.

FEATURES

Features

- Perfect digital high definition video sent over long stretches of HDMI cables
- Locate an HDMI display up to 200 feet away from any HDTV source
- Supports resolutions up to 1080p, 2K, and 1920 x 1200
- HDMI/HDCP compliant

Includes:

- (1) HDMI Super Booster Plus
- (1) 5V DC Power Supply
- (1) User's Manual

PANEL LAYOUT

Front Panel



Back Panel

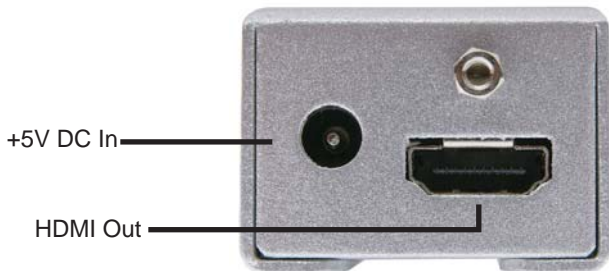

CONNECTING AND OPERATING THE HDMI SUPER BOOSTER PLUS

1. Connect the long HDMI cable from the source into the “HDMI In” on the front of the HDMI Super Booster Plus. The HDMI Super Booster Plus is placed next to your display to regenerate the HDMI cable.
2. Connect a short HDMI cable from the “HDMI Out” connection in the back of the HDMI Super Booster Plus to your display or projector
3. Plug the 5V DC power supply into the HDMI Super Booster Plus.
4. Plug the 5VDC wall mount power supply into the wall outlet.
5. Adjust the trim pot on the front of the unit to tune the signal and eliminate any video noise.

Note: Instead of manually adjusting the EQ to reduce image noise, the HDMI Super Booster Plus has the ability to do auto equalization. To enable the Auto EQ, remove the silver sticker on the bottom of the unit to reveal the service dip switch. By default, the switches should both be in the OFF position. Flip dip switch 1 to the ON position to enable Auto EQ. If the image is degraded or has any video noise in this mode, please disable the Auto EQ and adjust the image manually.

AUTO EQUALIZATION

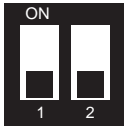

Auto EQ OFF
(Default)

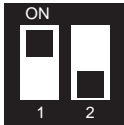

Auto EQ ON

Remove the silver
tape to expose the
Dip Switch Bank

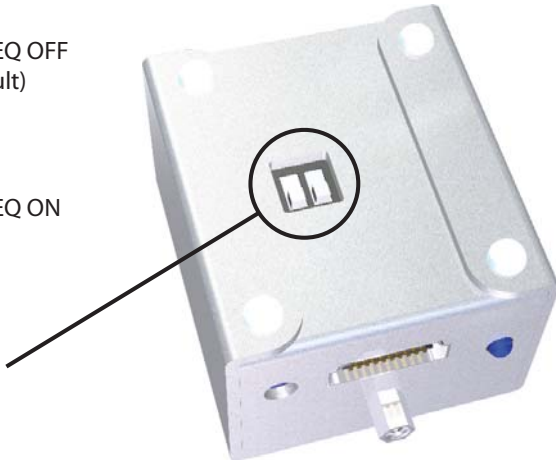

By default, both Dip Switches should be in the off position as shown above. To enable the Auto EQ, please flip Dip Switch 1 to the ON position. You must then proceed to manually adjust the EQ by turning the EQ trim pot on the front of the unit in small increments. It is important to turn the dial in very small increments as the “sweet spot” at which all video noise is eliminated can be very small.

SPECIFICATIONS

Video Amplifier Bandwidth	165 MHz
Input Video Signal	1.2 Volts p-p
Input DDC Signal	5 Volts p-p (TTL)
Maximum Single Link Range	1920 x 1200 x 60hz
HDMI Input/Output Connector Type	HDMI Type A
Power Consumption	5 Watts (max)
Power Supply.....	5V DC
Dimensions	1.75"W x 1"H x 2.25"D
Shipping Weight	2 Lbs